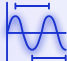
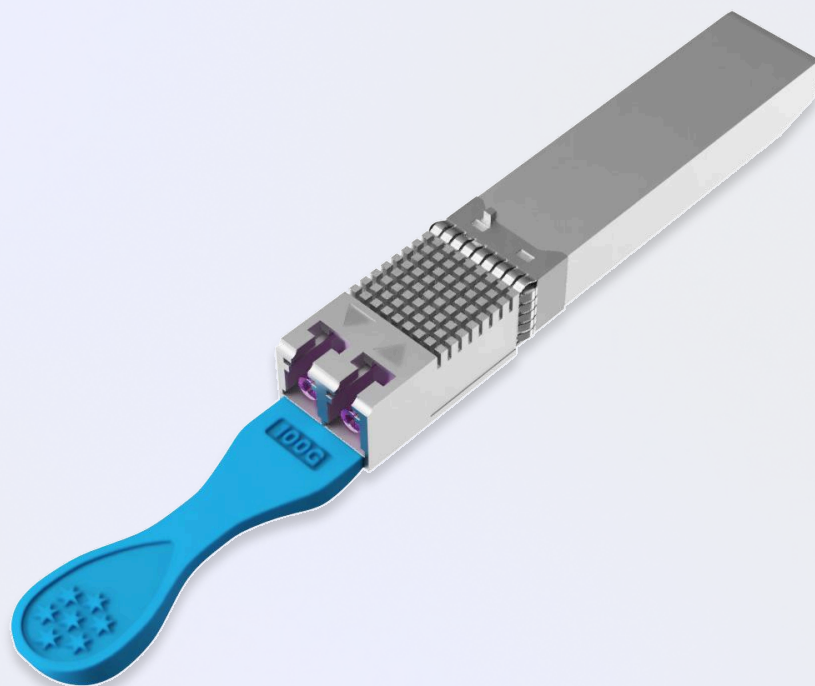

100G-SFP-DD-20

Optical Transceivers

 $\lambda = 2 \times 1310 \text{ nm}$

Fiber Type: OS2

Double LC

OB 7.4 dB

Max 20 km

FEC

 $PC \leq 3W$

Product description

100G-SFP-DD-20 is a 100GBASE LR1 Multi-Vendor MSA Compatible SFP-DD (Small Form-Factor Pluggable – Double Density) Transceiver designed for operation over Single-Mode Fiber (SMF) optical cable. On the transmission side module converts 2x 50G PAM4 (Pulse-Amplitude Modulation) electrical input channels (each 53.125Gbps) into 1x independent 100G PAM4 (106Gbps) optical signal. Module has minimum guaranteed optical budget of 7.4 dB, which in most cases is enough to reach 20 km distance over OS2 single-mode fiber. 100G-SFP-DD-20 uses top quality EML (1310 nm) transmitter and 106.25Gb/s PAM4 PIN photodiode receiver. 100G-SFP-DD-20 100GBASE-LR1 supports DDM/DOM optical diagnostics that provide real-time diagnostic information about the present operating conditions. 100G-SFP-DD-20 operates in Standard 0°-70°C temperature range and has Double LC interface. 100G-SFP-DD-20 100GBASE-LR1 SFP-DD transceiver is CE/RoHS certified and is compliant to SFP56-DD Multi Source Agreement (MSA), IEEE802.3CU, 100G Lambda 100G LR1 and 100GAUI-2(no FEC). We will be glad to know your requirements!

Product Specification:

Media Type:	Single-Mode Fiber (SMF)
Connectors:	Double LC
TX Wavelength:	1310 nm
RX Wavelength:	1310 nm
Minimum Optical Budget:	7.4 dB
Maximum Distance:	20 km
Supported Data Rate:	106.25 Gbps
Supported Applications:	100G Ethernet

Product Specification:

DDM/DOM:	Supported
Forward Error Correction (FEC):	Host FEC Supported
Transmitter Type:	EML Laser
Tx Wavelength Bandwidth:	13 nm
Average Launch Power (Min) Each Lane:	-0.2 dBm
Average Launch Power (Max) Each Lane:	6.6 dBm
Extinction Ratio (Min):	3.5 dB
Receiver Type:	PIN photodiode
Rx Wavelength Bandwidth:	13 nm
Avg Receiver Sensitivity(Min)Each Lane:	-7.6 dBm
Avg Receiver Sensitivity(Max)Each Lane:	6.6 dBm
Receiver Overload:	6.6 dBm
Temperature Range:	Standard 0°-70°C
Storage Temperature:	-40° to 85°C
Relative Humidity:	5 to 85%
Power Consumption:	≤3W
Power:	3.3V
Compliance:	100G Lambda 100G LR1, SFP56-DD MSA, IEEE802.3CU, 100GAUI-2(no FEC), RoHS

Mechanical Dimensions

*The dimensions are given in millimetres [mm]

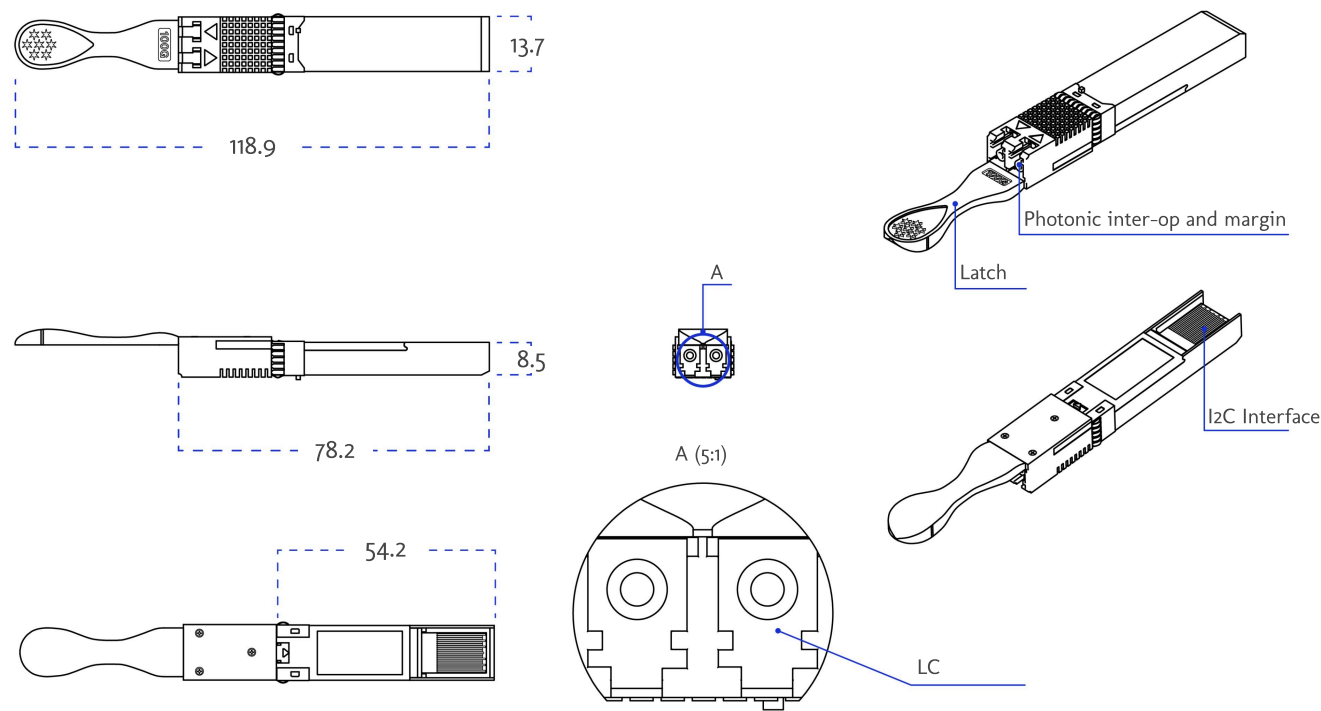

Warranty

EDGE Optic's provides a limited warranty for **sixty (60) months** from Purchaser's receipt of the Equipment represented in this data sheet against defective design or workmanship.



EDGE Technologies Ltd.
Plienciema Street 33, Marupe,
Latvia, LV-2167

+371 22084457
www.edgeoptic.com
sales@edgeoptic.com

