

400G-QSFP-DD-101

Optical Transceivers



$\lambda = 850 \text{ nm}$



Fiber Type: OM4



MTP/MPO-12

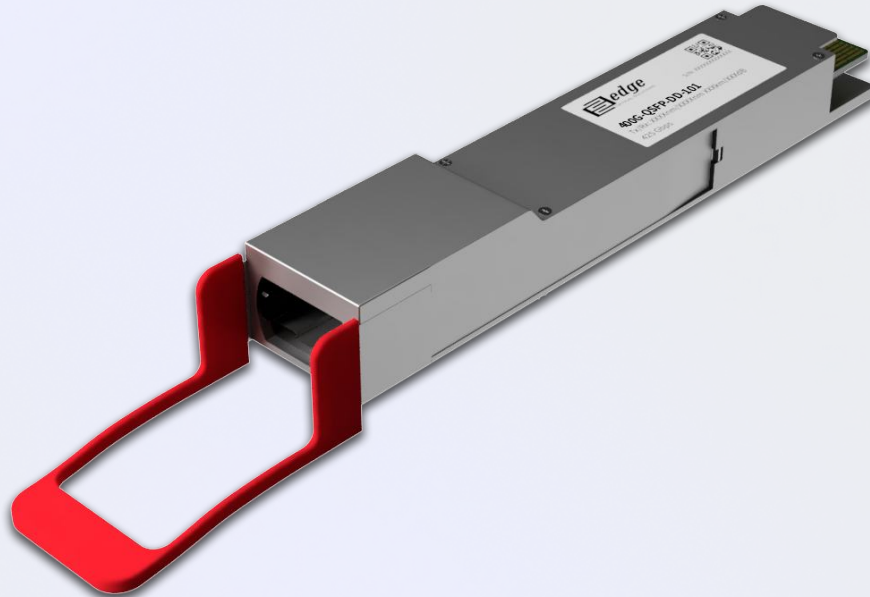

OB 1.8dB



Max 100 m



FEC



PC \leq 9W

Product description

400G-QSFP-DD-101 is a 400GBASE-SR4 Multi-Vendor MSA Compatible QSFP-DD (Quad Small Form-Factor Pluggable – Double Density) Transceiver designed for operation over Multi-Mode Fiber (MMF) optical cable. On the transmission side module converts 8x 50G 400GAUI-8 PAM4 (Pulse-Amplitude Modulation) electrical input channels (each 53.125Gbps) into 4 parallel and independent Single Lambda 100G PAM4 optical signals. Reversely the opposite is done on the receiving side, module converts 4 parallel and independent Single Lambda 100G PAM4 CWDM optical signals into 8x 50G 400GAUI-8 PAM4 electrical inputs. Module has minimum guaranteed optical budget of 1.8 dB, which in most cases is enough to reach 100 m distance over OM4 multi-mode fiber. 400G-QSFP-DD-101 uses top quality quad channel VSCSEL driver together with 4 parallel VSCSELs (850 nm) transmitter and 400Gb/s PIN photodiode array receiver. 400G-QSFP-DD-101 400GBASE-SR4 supports DDM/DOM optical diagnostics that provide real-time diagnostic information about the present operating conditions. 400G-QSFP-DD-101 operates in Standard 0°-70°C temperature range and has MTP/MPO-12 interface. 400G-QSFP-DD-101 400GBASE-SR4 QSFP-DD transceiver is CE/RoHS certified and is compliant with product safety standards. 400G-QSFP-DD-101 is fully compliant to QSFP-DD Multi Source Agreement (MSA), 100G Lambda MSA 400G-DR4, CMIS 5.2, IEEE 802.3bs and IEEE 802.3db 400 Gbps specification. We will be glad to know your requirements!

Product Specification:

Media Type:	Multi-Mode Fiber (MMF)
Connectors:	MTP/MPO
TX Wavelength:	850 nm
RX Wavelength:	850 nm
Minimum Optical Budget:	1.8 dB
Maximum Distance:	100 m
Supported Data Rate:	425 Gbps

Product Specification:

Supported Applications:	400G Ethernet
DDM/DOM:	Supported
Forward Error Correction (FEC):	Host FEC Supported
Transmitter Type:	VSCSEL Laser
Tx Wavelength Bandwidth:	19 nm
Average Launch Power (Min) Each Lane:	-4.6 dBm
Average Launch Power (Max) Each Lane:	4 dBm
Extinction Ratio (Min):	2.5 dB
Receiver Type:	PIN photodiode
Rx Wavelength Bandwidth:	19 nm
Avg Receiver Sensitivity(Min)Each Lane:	-6.4 dBm
Avg Receiver Sensitivity(Max)Each Lane:	4 dbm
Receiver Overload:	5 dBm
Temperature Range:	Standard 0°-70°C
Storage Temperature:	-40° to 85°C
Relative Humidity:	0 to 85%
Power Consumption:	≤ 9W
Power:	3.3V
Compliance:	400GBASE-SR4, IEC60825-1 Laser Safety Compliant, CMIS 5.2, IEEE 802.3db , IEEE 802.3bs , QSFP-DD MSA, RoHS-6, CE

Mechanical Dimensions

*The dimensions are given in millimetres [mm]

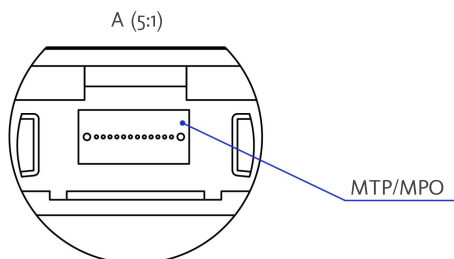
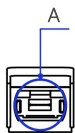
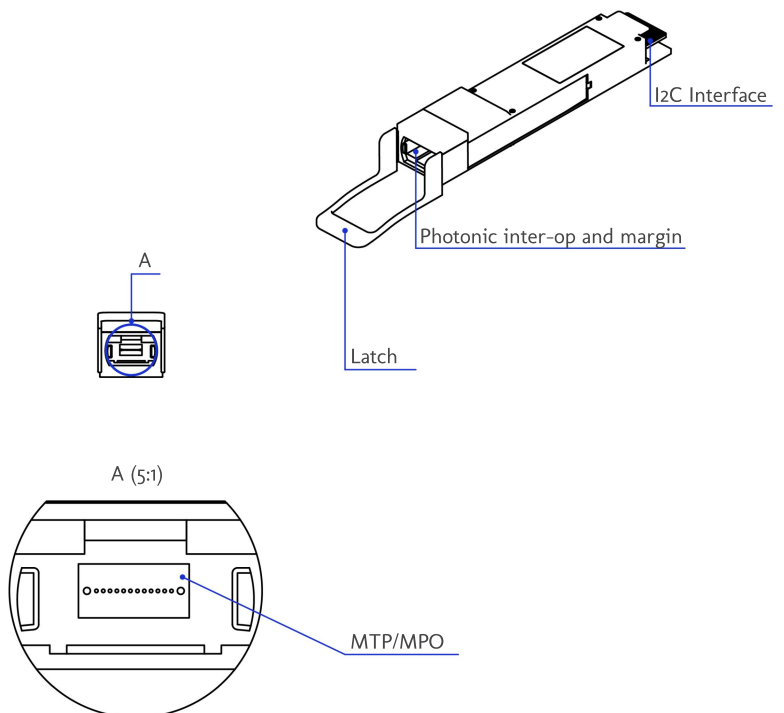
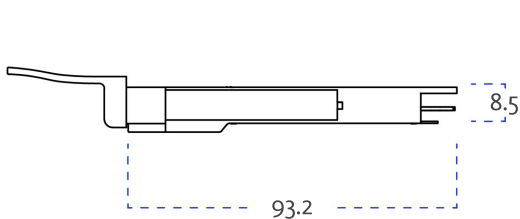
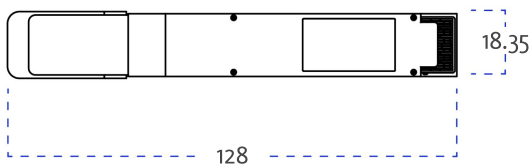

Warranty

EDGE Optic's provides a limited warranty for **sixty (60) months** from Purchaser's receipt of the Equipment represented in this data sheet against defective design or workmanship.



EDGE Technologies Ltd.
Plienciema Street 33, Marupe,
Latvia, LV-2167

+371 22084457
www.edgeoptic.com
sales@edgeoptic.com

